

# Turnpike/SR 50 Widening Orange County

Traffic Shift Eastbound SR 50 to  
Southbound Turnpike

# Turnpike Enterprise Construction

## Minute 8/21/09

- Starting the morning of 8/21/09 (weather permitting) EB traffic on SR-50 will shift to the new widening for improved access to the SB Turnpike. Eastbound SR 50 will open to three (3) lanes 1/8th of a mile west of Remington Rd. Access to the new SB Ramp will be from the center or right. Thru traffic on SR-50 will need to be in the center or left lane.

-Traffic travelling eastbound on SR 50 and continuing on SR 50 through the Turnpike Interchange will need to stay to the left.

- Traffic travelling westbound on SR 50 to southbound Turnpike will remain in the same alignment as it has been, except this ramp ties into the new alignment near the toll plaza more abruptly. **Caution is required where traffic merges just prior to the toll plaza and a “Yield” sign will be placed on this ramp.**



Traffic Light at  
Remington Road

Begin new alignment for Eastbound Lanes  
for SR 50 approaching Remington Rd.



New alignment for Eastbound Lanes for SR 50 approaching Remington Rd.



Lanes to SR 50 EB

Lane to Turnpike SB

Lane to SR 50 EB or  
Turnpike Southbound

SR 50 Westbound Ramp to  
Southbound Turnpike . Traffic  
is to “YIELD” prior to merging.



Lanes to Southbound Turnpike  
from SR 50 Eastbound

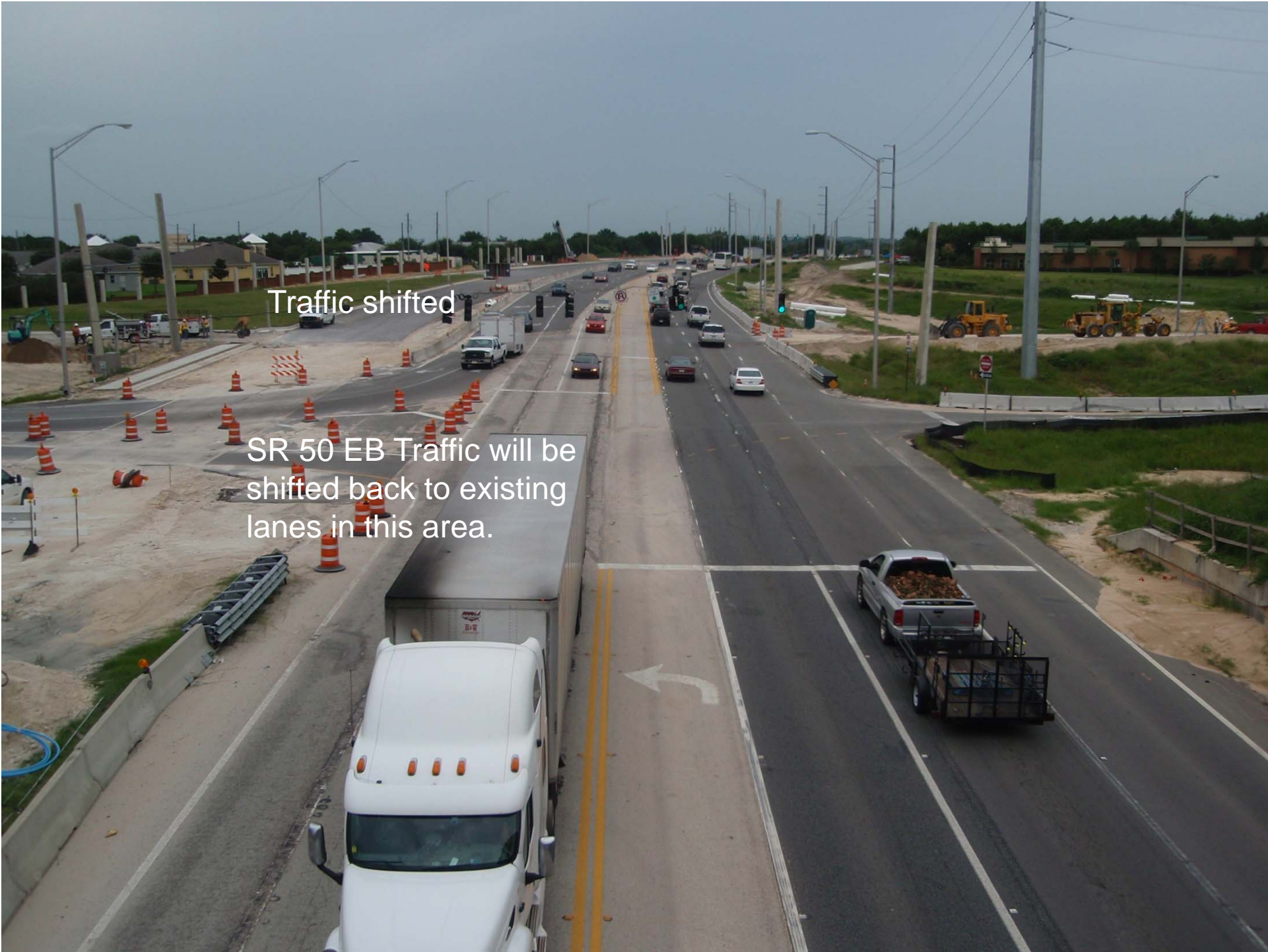

Traffic shifted

SR 50 EB Traffic will be shifted back to existing lanes in this area.